

Basis of Adjacent Ways – Laveen Elementary School Pre K-8 ES#10 - GMP #1 – Site Portion of Work

This cost is to cover the Bus and Fire equipment access lanes throughout the site and off-site roadwork. The scopes of work that fall within these boundaries are as follows: Surveying & Staking, Earthwork & Paving, Site Concrete, Utilities, and Signage & Striping.

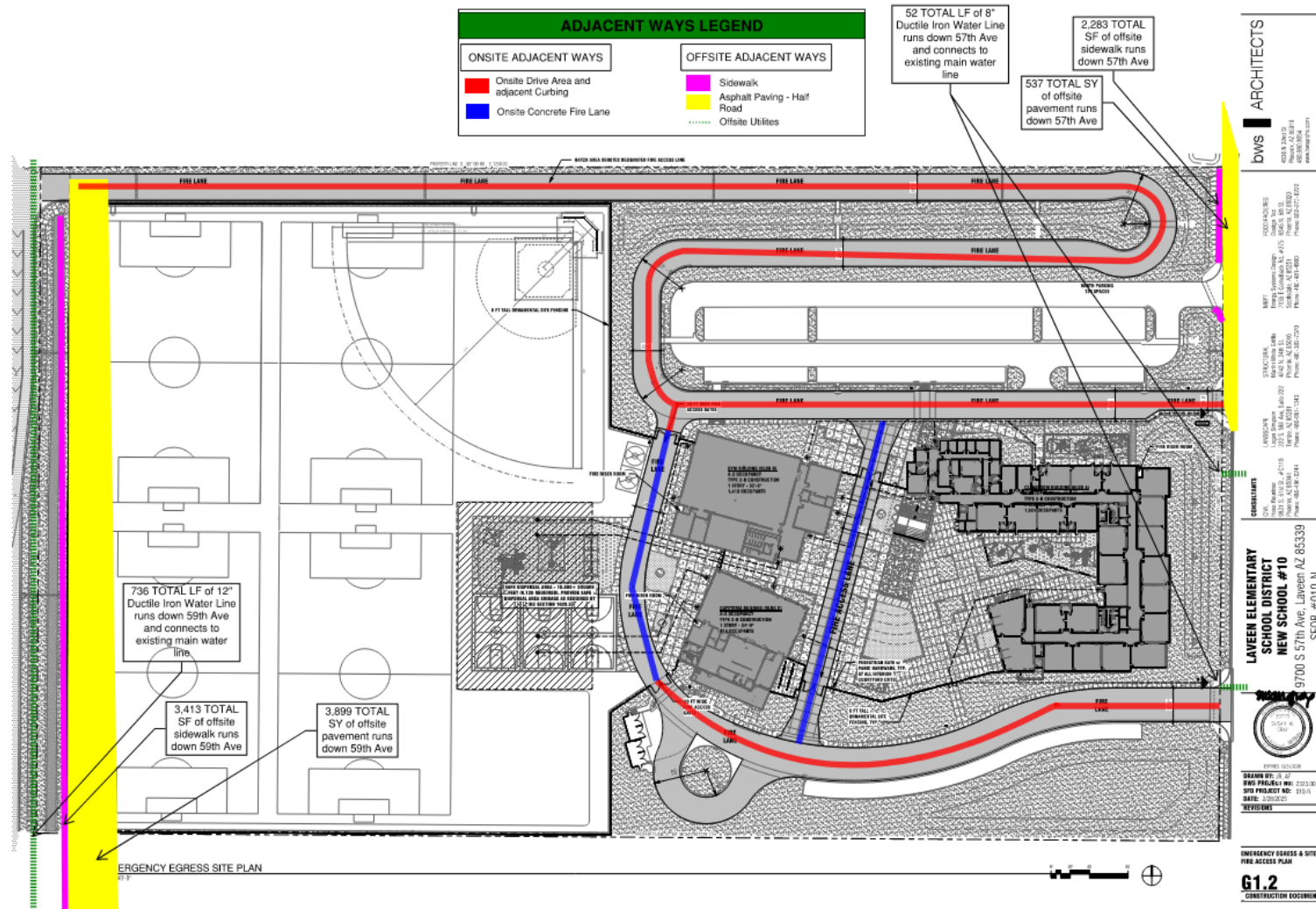

A. On-Site Adjacent Ways

G1.2 The **RED area** represents the Fire Lane & Bus Queuing Lane and includes:

- Heavy Duty Asphalt (3" over 8" ABC)
- Asphalt Drive Entrance
- 6" Concrete Curb
- Directional Arrows

G1.2 The **BLUE area** represents the Fire Lane and includes:

- Concrete Pavement (7" Thick MAG AA)
- Fire Lane "No Parking" Signs per City of Phoenix Fire Department Fire Prevention Program
- Directional Arrows

B. Off-Site Adjacent Ways

G1.2 The **YELLOW area** represents the Off-site Pavement Area and includes:

- Heavy Duty Asphalt (5" over 7" ABC) w/ Compacted Subgrade
- 6" Curb & Gutter
- Concrete Pedestrian Ramps
- Adjust Valve/Manhole

G1.2 The **PINK area** represents the Concrete Sidewalk and Decomposed Granite includes:

- 4" Concrete Sidewalk (MAG 230)
- Decomposed Granite
- Concrete Aprons
- ADA Ramps
- Sidewalk Ramps

G1.2 The **GREEN Dotted line** represents the 18" Off-Site Storm Pipe and includes:

- 12" Ductile Iron Water Line Pipe
- 8" Ductile Iron Water Line Pipe
- Remove Blow-Off Valve & Connect to Existing Water Line
- Trenching

revised 2/16/2021

Page 1 of 6

Schedule of Values

revised 2/16/2021

		District Cost	On-Site Adjacent Ways	Off-Site Adjacent Ways
Div 5	METALS			
05 00 00	miscellaneous steel			
05 10 00	structural steel			
05 30 00	metal decking			
05 51 00	stairs			
05 70 00	architectural steel			
	Division 5 total	\$0.00	\$0.00	\$0.00
Div 6	WOODS/PLASTICS/COMPOSITES			
06 10 00	rough carpentry structure			
06 15 00	wood decking			
06 20 00	finish carpentry			
06 40 00	millwork/casework			
06 60 00	plastic/glass fiber			
	Division 6 total	\$0.00	\$0.00	\$0.00
Div 7	THERMAL/MOISTURE			
07 10 00	waterproofing/dampproofing			
07 20 00	building insulation			
07 21 00	foam roof			
07 25 00	weather barrier			
07 31 00	roof shingles			
07 32 00	roof tiles			
07 50 00	membrane roofing			
07 60 00	metal roof			
07 60 00	general sheet metal			
07 72 00	roof accessories			
07 81 00	sprayed fireproofing			
07 84 00	firestopping			
07 95 00	roof expansion joint			
07 92 00	joint sealants			
	Division 7 total	\$0.00	\$0.00	\$0.00
Div 8	OPENINGS			
81 10 00	doors & frames			
08 33 00	overhead doors			
08 40 00	storefronts			
08 44 00	curtain walls			
08 50 00	windows			
08 60 00	skylights			
08 70 00	hardware			
08 71 13	automatic doors			
08 79 00	knox box			
08 80 00	glass & glazing			
	Division 8 total	\$0.00	\$0.00	\$0.00

Schedule of Values

revised 2/16/2021

		District Cost	On-Site Adjacent Ways	Off-Site Adjacent Ways
Div 9	FINISHES			
09 24 00	stucco/EIFS systems			
09 20 00	interior metal studs/gypsum board			
09 22 00	exterior metal stud framing			
09 23 00	decorative plaster			
09 51 00	acoustical ceilings			
09 31 00	ceramic tile			
09 65 00	resilient flooring			
09 68 00	carpet			
09 64 00	wood floors			
09 67 00	epoxy			
09 80 00	sound panels			
09 90 00	painting			
09 77 00	fiberglass reinforced panels			
	Division 9 total	\$0.00	\$0.00	\$0.00
Div 10	SPECIALTIES			
10 11 00	visual display boards			
10 14 00	signage			
10 21 13	toilet partitions & accessories			
10 21 23	cubicle track & curtain			
10 22 26	operable partitions/walls			
10 26 00	wall protection			
10 44 00	fire extinguishers & cabinets			
10 50 00	lockers			
10 56 13	storage shelving			
10 73 00	shelters			
10 73 13	awnings			
10 73 13	canopy/ramada			
10 75 00	flagpoles			
	Division 10 total	\$0.00	\$0.00	\$0.00
Div 11	EQUIPMENT			
11 16 16	floor safe			
11 41 00	kitchen equipment			
11 51 00	library equipment			
11 52 00	audio/visual equipment			
11 52 13	projection screens			
11 53 13	fume hoods			
11 61 43	stage curtain/equipment			
11 66 00	sports/PE equipment			
11 68 00	playground equipment			
11 68 23	site basketball courts			
11 68 33	ballfield backstop			
11 68 33	sports fields			
	Division 11 total	\$0.00	\$0.00	\$0.00

Schedule of Values

revised 2/16/2021

		District Cost	On-Site Adjacent Ways	Off-Site Adjacent Ways
Div 12	FURNISHINGS			
12 20 00	window coverings			
12 31 00	metal casework			
12 32 16	plastic laminate casework			
12 61 00	auditorium seating			
12 93 13	bike racks			
12 93 23	trash enclosures			
	Division 12 total	\$0.00	\$0.00	\$0.00
Div 13	SPECIAL CONST			
13 00 00	equipment/storage enclosures			
13 11 00	swimming pools			
13 34 16	bleachers			
13 34 19	metal buildings			
	Division 13 total	\$0.00	\$0.00	\$0.00
Div 14	CONVEYING			
14 00 00	material handling			
14 20 00	elevators			
14 42 00	wheelchair lifts			
	Division 14 total	\$0.00	\$0.00	\$0.00
Div 21	FIRE SUPPRESSION			
21 10 00	fire protection/sprinklers			
	Division 21 total	\$0.00	\$0.00	\$0.00
Div 22	PLUMBING			
22 11 00	supply piping			
22 13 00	waste water piping			
22 31 00	water treatment (softner)			
22 32 00	water treatment (filtered)			
22 35 00	water heaters			
22 42 00	plumbing fixtures			
	Division 22 total	\$0.00	\$0.00	\$0.00
Div 23	MECHANICAL			
23 07 13	mechanical insulation			
23 50 00	HVAC - central plant (cooling)			
23 60 00	HVAC - central plant (heating)			
23 76 00	HVAC - evaporative			
23 80 00	HVAC - package units			
23 81 26	HVAC - split system			
	Division 23 total	\$0.00	\$0.00	\$0.00
Div 25	INTEGRATED AUTOMATION			
25 50 00	EMS			
	Division 25 total	\$0.00	\$0.00	\$0.00

Schedule of Values

revised 2/16/2021

		District Cost	On-Site Adjacent Ways	Off-Site Adjacent Ways
Div 26	ELECTRICAL			
26 10 00	site electrical			\$40,500.00
26 10 00	electrical			
26 30 00	generators			
26 56 00	exterior lighting			
	Division 26 total	\$0.00	\$0.00	\$40,500.00
Div 27	COMMUNICATIONS			
27 20 00	data cabling			
27 24 00	TV cabling			
27 30 00	intercom			
27 32 13	communications/phone			
	Division 27 total	\$0.00	\$0.00	\$0.00
Div 28	SAFETY AND SECURITY			
28 10 00	security system			
28 20 00	surveillance/alarm			
28 31 00	fire alarm system			
	Division 28 total	\$0.00	\$0.00	\$0.00
Div 31	EARTHWORK			
31 23 00	earthwork/mass excavation			
31 23 00	import/export dirt			
31 31 00	soil treatment - termite			
	Division 31 total	\$0.00	\$0.00	\$0.00
Div 32	EXTERIOR IMPROVEMENTS			
32 00 00	parking			
32 00 00	unusal site conditions			
32 10 00	asphalt/paving		\$416,631.60	\$339,788.40
32 13 00	fire lane site concrete		\$343,379.00	\$120,571.00
32 13 00	sidewalks (only for bus drop-offs)			
32 17 00	striping/signage		\$7,396.00	\$14,700.00
32 31 13	chainlink fencing			
32 31 19	wrought iron fencing			
32 32 00	retaining walls			
32 80 00	irrigation			
32 90 00	landscaping			\$2,953.00
	Division 32 total	\$0.00	\$767,406.60	\$478,012.40

Schedule of Values

revised 2/16/2021

		District Cost	On-Site Adjacent Ways	Off-Site Adjacent Ways
Div 33	UTILITIES			
33 00 00	site utilities			\$467,650.00
33 21 00	wells			
33 32 16	lift station			
33 36 00	septic system			
33 40 00	stormwater/drainage			
33 49 23	drywells			
	Division 33 total	\$0.00	\$0.00	\$467,650.00
	Subtotal	\$0.00	\$788,706.60	\$1,004,292.40
	A/E Fee			
	Contractor Fee		\$66,727.27	\$52,403.30
	Project Manager Fee			
	General Conditions		\$70,706.18	\$55,528.08
	Contractor Contingency		\$74,734.54	\$58,691.40
	Builders Risk/Liability Insurance		\$34,087.83	\$26,770.39
	Performance & Payment Bonds		\$13,345.45	\$10,480.66
	Sales Tax		\$70,651.66	\$55,485.26
	Subtotal	\$0.00	\$330,252.92	\$259,359.08
	Grand Subtotal	\$0.00	\$1,118,959.52	\$1,263,651.48
	Project Grand Total	\$2,382,611.00		
	Adjacent Ways Grand Total	\$2,382,611.00		